

VS10 Mixer Seal Type

Operating Limits	
Pressure	Full Vacuum up to 50kg/cm ²
Velocity	Up to 15m/sec
Viscosity	100cp
Temperature	-30°C to 205°C
Slurry	up to 0.1%

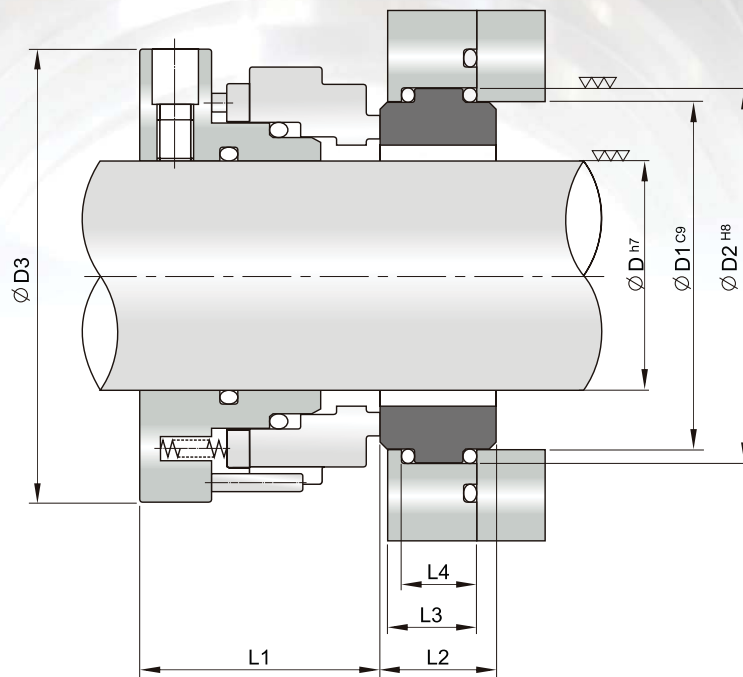

Mixer Seal Type

SIZE	D	D1	D2	D3	L1	L2	L3	L4
030	30	53,98	59,98	76,2	55,63	25,4	19,05	13,05
035	35	60,32	66,32	82,6	55,63	25,4	19,05	13,05
040	40	63,50	69,50	85,8	55,63	25,4	19,05	13,05
045	45	69,85	75,85	91,9	55,63	25,4	19,05	13,05
050	50	76,20	82,20	98,6	55,63	25,4	19,05	13,05
055	55	79,38	85,38	101,6	55,63	25,4	19,05	13,05
060	60	85,72	91,72	108,0	55,63	25,4	19,05	13,05
065	65	88,90	94,90	111,2	55,63	25,4	19,05	13,05
070	70	95,25	101,25	117,2	55,63	25,4	19,05	13,05
075	75	101,60	107,60	124,0	55,63	25,4	19,05	13,05
080	80	104,78	110,78	127,0	55,63	25,4	19,05	13,05
085	85	107,95	113,95	130,3	55,63	25,4	19,05	13,05
090	90	114,30	120,30	136,6	55,63	25,4	19,05	13,05
095	98	120,65	126,65	142,7	55,63	31,8	25,4	13,05
100	100	127,00	133,00	149,4	55,63	31,8	25,4	13,05
110	110	136,52	142,52	158,8	55,63	31,8	25,4	13,05
120	120	146,05	152,05	168,1	55,63	31,8	25,4	13,05
130	130	155,58	161,58	177,8	55,63	31,8	25,4	13,05
140	140	165,10	171,10	187,4	55,63	31,8	25,4	13,05
150	150	174,62	180,62	196,8	55,63	31,8	25,4	13,05
160	160	187,32	193,32	209,6	55,63	31,8	25,4	13,05
170	170	196,85	202,85	218,9	55,63	31,8	25,4	13,05
180	180	203,2	209,20	225,6	55,63	31,8	25,4	13,05

Operating Limits	
Pressure	Full Vacuum up to 30kg/cm ²
Velocity	Up to 15m/sec
Viscosity	100cp
Temperature	-20°C to 205°C
Slurry	up to 0.1%

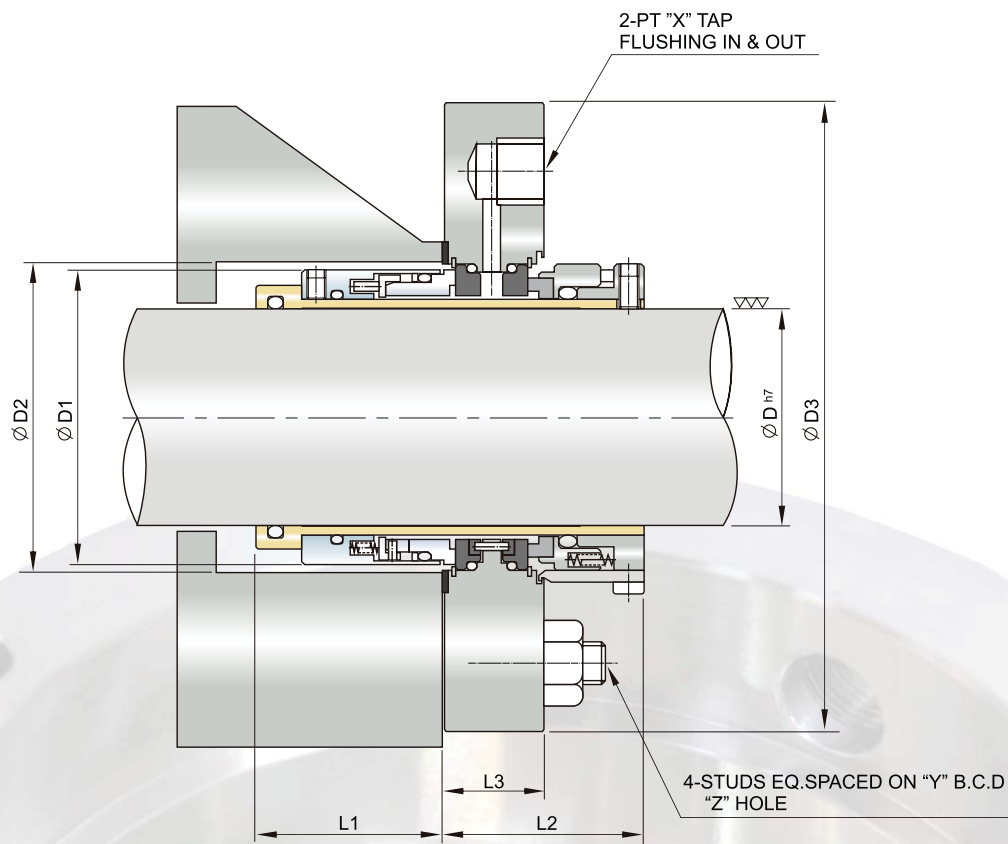

Double Cartridge Seal

SIZE	D	D1	D2		D3	L1	L2	L3	X	Y	Z
			Min.	Max.							
025	25	42,2	44	49	95	43	50,8	25,8	3/8"	70	11,2
028	28	46,0	48	52	98	43	50,8	25,8	3/8"	76,2	14,3
030	30	49,2	51	55	108	42,5	50,8	25,8	3/8"	79,4	14,3
035	35	55,5	58	65	120	44,5	50,8	25,8	3/8"	95,2	14,3
040	40	58,7	61	68	120	44,5	50,8	25,8	3/8"	95,2	14,3
045	45	65,1	67	74	127	47,5	50,8	25,8	3/8"	98,4	14,3
050	50	71,4	73	84	152	47,5	50,8	25,8	3/8"	111,1	17,5
055	55	74,6	77	87	165	47,5	50,8	25,8	3/8"	117,5	17,5
060	60	84,1	86	96	168	52,5	52,5	28,2	3/8"	127,0	17,5
065	65	87,3	89	100	184	52,5	52,5	28,2	3/8"	146,0	20,7

SSU-1 Agitator Seal Unit

Operating Limits	
Pressure	Full Vacuum up to 10kg/cm ²
Velocity	Up to 15m/sec
Viscosity	300cp
Temperature	-30°C to 250°C
Slurry	up to 0.5%

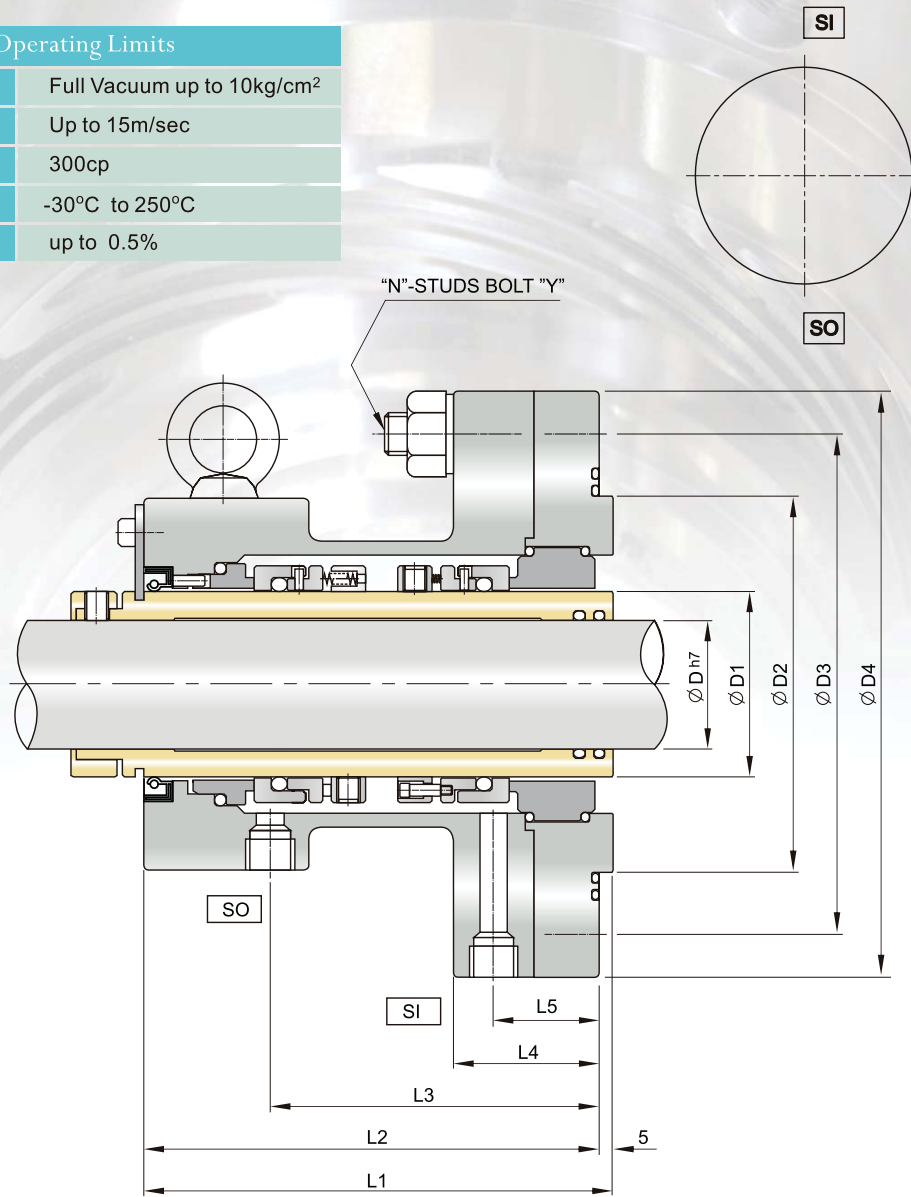

NO	SERVICE	CONNECTION
SI	SEALANT INLET	PT 3/8"
SO	SEALANT OUTLET	PT 3/8"

Agitator Seal Unit

SIZE	D	D1	D2	D3	D4	L1	L2	L3	L4	L5	N	Y
060	40	60	115	170	200	198	193	118	51	37	6	16
070	50	70	125	180	210	206	201	122	55	41	8	16
080	60	80	135	190	220	208	203	124	55	41	8	16
090	70	90	145	200	230	208	203	124	55	41	8	16
100	80	100	155	215	255	211	206	127	57	41	8	20
110	90	110	165	225	265	212	207	127	57	41	8	20
120	100	120	185	245	285	218	213	133	57	41	8	20
130	110	130	195	255	295	218	213	133	57	41	8	20
140	120	140	205	265	305	221	216	136	60	46	8	20
150	130	150	220	280	320	221	216	136	60	46	8	20

Operating Limits	
Pressure	Full Vacuum up to 30kg/cm ²
Velocity	Up to 10m/sec
Viscosity	300cp
Temperature	-30°C to 250°C
Slurry	up to 0.5%

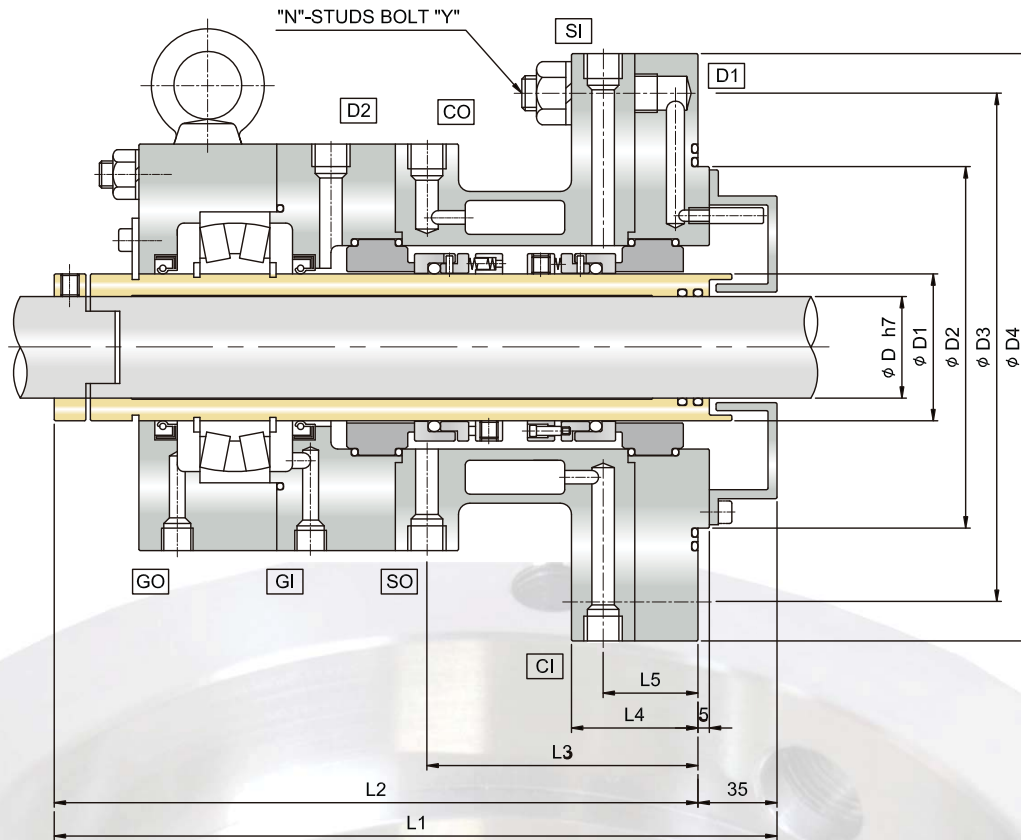
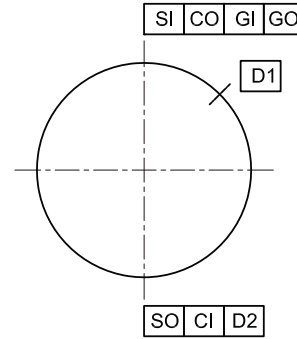

NO	SERVICE	CONNECTION	NO	SERVICE	CONNECTION
SI	SEALANT INLET	PT 3/8"	D1	DRAIN HOLE	PT 3/8"
SO	SEALANT OUTLET	PT 3/8"	D2	DRAIN HOLE	PT 3/8"
CI	COOLING WATER INLET	PT 3/8"	GI	GREASE INLET	PT 1/4"
CO	COOLING WATER OUTLET	PT 3/8"	GO	GREASE OUTLET	PT 1/4"

Agitator Seal Unit

SIZE	D	D1	D2	D3	D4	L1	L2	L3	L4	L5	N	Y
060	40	60	160	215	255	320	285	120	56	42	8	20
070	50	70	175	230	270	333	298	126	60	46	12	20
080	60	80	190	245	285	337	302	126	60	46	12	20
090	70	90	210	265	305	344	309	126	60	46	12	20
100	80	100	235	300	345	356	321	130	62	48	12	24
110	90	110	255	320	365	367	332	130	62	48	12	24
120	100	120	270	335	380	378	343	136	62	48	12	24
130	110	130	285	350	395	384	349	136	62	48	12	24
140	120	140	305	370	415	394	359	139	65	51	12	24
150	130	150	325	390	435	399	364	139	65	51	12	24

SW-200S Gas Barrier Dry-Running Seal

SEPA CO., LTD.

Operating Limits	
Pressure	max Barrier Pressure 125 psig
Velocity	0 ~ 225 rpm
Temperature	-30°C to 150°C

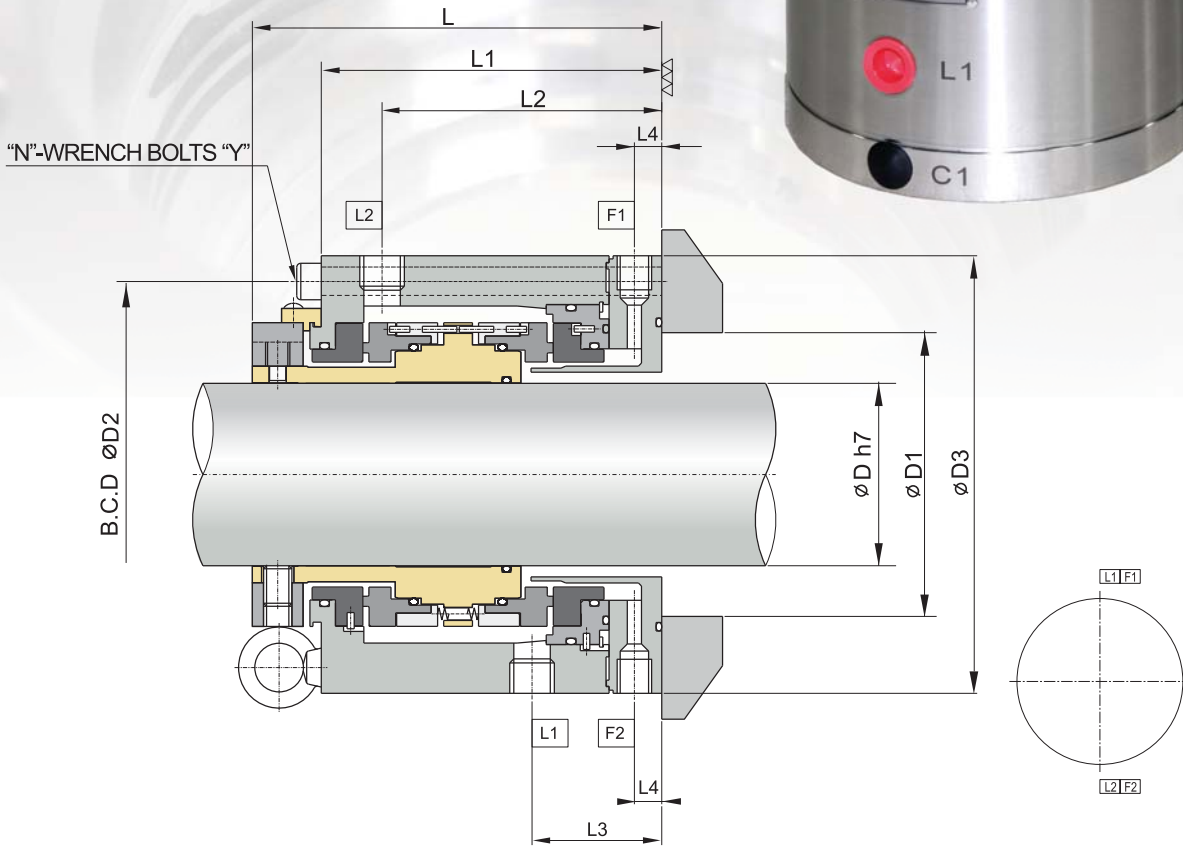

NO	SERVICE	CONNECTION
L1	SEALANT INLET	PT1/2
L2	SEALANT OUTLET	PT1/2
F1	FLUSH INLET	PT3/8
F2	FLUSH OUTLET	PT3/8

Gas Barrier Dry-Running Seal

SIZE	D	D1	D2	D3	L	L1	L2	L3	L4	N	Y
50	50	90	145	170	180	152	123	60	13.5	4	12
60	60	100	155	180	180	152	123	60	13.5	4	12
70	70	110	165	190	186	158	129	62	13.5	4	12
80	80	120	175	200	186	158	129	62	13.5	4	12
90	90	130	185	210	202	168	138	64	13.5	4	12
100	100	140	195	220	202	168	138	64	13.5	4	12
110	110	148	205	230	209	175	143	64	13.5	4	12
120	120	160	215	240	209	175	143	64	13.5	4	12
130	130	168	225	250	217	183	148	66	13.5	4	12
140	140	180	235	260	217	183	148	66	13.5	4	12

LCT 5300 SEALANT VESSEL WITH COOLING COIL

No	Nozzel Orientation	Connection
C1	Cooling Water In/Outlet	PT 3/8"
C2	Cooling Water Out/Inlet	PT 3/8"
F1	Sealant Filling	PT 3/8"
F2	External Pressure Source	PT 3/8"
L1	Sealant Return (Outlet From Seal)	PT 3/8"
L2	Sealant Supply (Inlet to Seal)	PT 3/8"
D	Drain Hole	PT 3/8"

Note : Seal Connection 일치

